

ARTIST'S BRIEF
ForM Sculpture Exhibition
Bangor Castle Walled Garden
Monday 1 – Tuesday 30 June 2020



Submission Deadline: Monday 3 February 2020, 12noon

1. Submission Criteria

Participation in the exhibition is through a selection process, or invitation. A selection panel will include the arts officer and independent curators who will meet to review all submissions.

The selection panel will select work based on the following criteria:

- The quality of the proposal
- How appropriate the proposed work is within the garden environment, e.g. content, material, display.
- Ability to deliver the proposed work based on images of previous work.

2. Awards

This year we are pleased to offer two awards to selected artists.

- **Panel Vote Award:** £200 worth of artist materials of your choice
(Panel will consist of invited professionals from the Visual Arts/Crafts sectors and stakeholders)
- **Public Vote Award:** £200 worth of artist materials of your choice

Award Scoring

The award from the Panel Vote will be scored on the following criteria:

- Concept/theme of work in response to the environment of the Walled Garden
- Quality of work
- Originality of work

3. Artist's Brief

Artists are invited to make submissions for an open air exhibition in Bangor Castle Walled Garden, Valentine Road, Castle Park, Bangor, Co Down.

Designed by the Ward family in the 1840s the Walled Garden covers 1.5 acres. It had never been open to the public and was once rumoured to be a secret garden. North Down Borough Council restored the Garden to its original Victorian design and it was opened to the public in April 2009. The southern section of the Garden remains true to its Victorian roots. It is divided into four quadrants - the kitchen garden, the herb and topiary garden, the damp garden and the flower garden. These four areas are separated by avenues of spectacular pleached lime trees and rose covered arches. The northern section of the Garden offers visitor facilities including a small cafe, toilets and grassed area for picnics. The Garden is open to the public from Easter to the end of October each year.



Some images of the Walled Garden

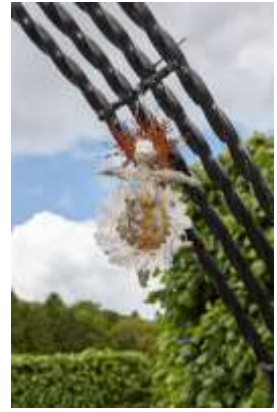

Some sculptures from previous years of ForM Sculpture Exhibition.

3. Artist's Brief (continued)...

- Artists are encouraged to make site-specific work/s or propose work that responds to the environment of Bangor Castle Walled Garden.
- Artwork should not alter or damage the garden in any way. It is possible to site work on grass areas but artists must be aware that artworks would be moved once a week to allow the grass to be cut, the majority of works are to be sited within the broad borders and amongst the planting.
- Artists are encouraged to consider hanging works from the red brick walls of the garden, the walls are already strung with high tensile wires.
- The exhibition benefits from a variety of scale and therefore larger scale works are encouraged.
- The only areas that are out of bounds for artworks are the greenhouses and the bandstand.
- **Artists should consider that the garden is open to the public and work should be durable, safe, weather-proof and be able to last the duration of the exhibition.**

It is recommended that Artist's attend a site visit before proposing works if possible (see dates page 4). Artists are invited to propose ideal locations for artworks in their submissions. **Every effort will be made to locate artworks in the proposed location, but ultimately location is at the discretion of the curatorial panel.**

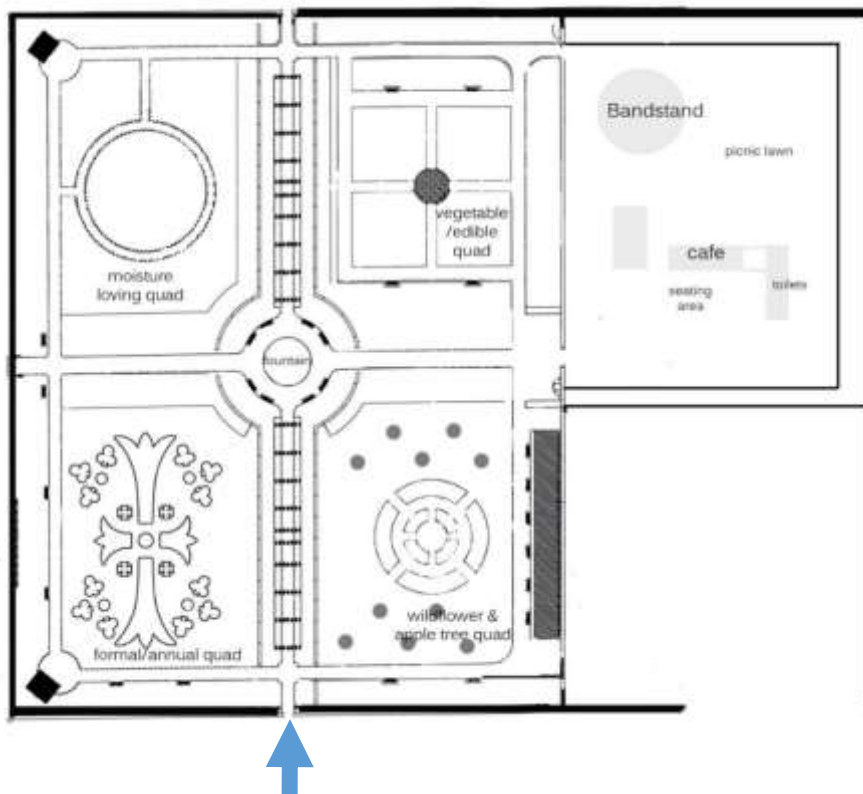

Map of garden showing two entrances and how path divides it into four quarters.

Entrance from Aurora Leisure Centre Car Park

4. Dates

Artists proposing work should take note of all the important dates below.

Site visits	<p>There will be two site visits for artists to choose to attend to aid with their planning of work before the application deadline:</p> <ul style="list-style-type: none">• Thursday 19 December 2019, 1pm• Tuesday 28 January 2020, 1pm <p>Registration is essential. Please email arts@ardsandnorthdown.gov.uk or telephone 028 9181 0803.</p> <p>Meet at the Aurora Car park entrance to the Walled Garden. A map of garden will be provided for artists.</p>
Submission deadline	Monday 3 February 2020, 12 noon
Notification to artists	Week commencing 17 February 2020 by e-mail.
Installation of artworks	Monday 25 May 2020 between 10.30am – 2pm <i>Work not delivered on this date will not be included in the exhibition.</i>
Exhibition Dates	Monday 1 – Tuesday 30 June 2020*
Exhibition officially opens	Saturday 30 May 2020 (please note artworks will be on display to the public from the date of installation)
<i>Exhibition continues until Tuesday 30 June 2020 inclusive</i>	
De-Installation & Collection	From Wednesday 1 until Sunday 5 July (during opening hours) Artists must arrange removal of artworks from Walled Garden (<i>after this date the artworks will remain at the artist's own risk</i>)
*Garden opening hours	Monday – Thursday 10am – 7.30pm Friday – Sunday 10am – 5.30pm

Please be advised that all dates are subject to change and artists will be advised if this is the case.

5. Submission Process and Requirements

Please note Submission to the exhibition is via an online application form.

If you have no access to a computer to complete the online application form, please contact us **no later than Monday 27 January 2020.**

It is recommended that artists save each page of the online form before submitting their response so ensure they do not lose their work.

All online submissions will receive an automated response with a unique reference code. Applicants should save this email for their records. If the applicant does not receive this response it may mean that the submission has not been received. It is the applicant's responsibility to contact us before the deadline during admin office hours on 028 9181 0803 to check the submission has been received.

Admin office hours:

Monday – Thursday: 9am – 5pm

Friday: 9am – 4.30pm

Saturday & Sunday: CLOSED

Submission requirements:

1. Completed online application form
2. An Artist Statement (max 1 page)
3. An Artists CV (max 2 pages)
4. 1-3 images* max (or sketches) of **each** of the proposed sculptures/artworks
5. 3-6 images* max of previous work (include information such as titles on separate page)

*Images should be of good quality, good resolution (no less than 1MB each), and clearly convey the proposed artworks. Images can convey different angles of an artwork if necessary (EG: 1 image from the front, and 1 image from the side).

Information should be included to explain the images/sketches of proposed works (EG: Titles, dimensions, materials, etc).

If you have any queries please send them via email to:

arts@ardsandnorthdown.gov.uk

or Tel: 028 9181 0803

Submission Deadline:

Monday 3 February 2020, 12 noon

Incomplete submissions, or submissions received after the deadline will not be accepted.

6. Guidance Notes - Conditions of Application/Exhibition

1. There is no submission fee and no commission fee will be applied to any work sold during the exhibition.
2. Submissions must be of a high standard, both in presentation and in content.
3. The submissions must convey the appearance of the proposed works.
4. Artists are responsible for delivery of artworks to the Walled Garden and for installation of artwork.
5. Artworks must be stable and secure and present no danger to the public, if artwork is deemed unstable or dangerous after installation it will be removed.
6. All work is to be installed under the supervision of the curatorial panel. Positioning of the artwork will be at the discretion of the curatorial panel.
7. All sculptures must be removed after the exhibition without causing any damage to the garden. Artworks must not be removed by the artist before the end of the exhibition.
8. Installation and removal of work will take place only on the allocated dates.
9. Artists are responsible for the maintenance of their artwork throughout the exhibition and will undertake any repair/replacement necessary to ensure quality remains for the duration of the exhibition.
10. The artist permits organisers to photograph the works for any publicity purposes in relation to the exhibition.
11. On delivery of artworks artists will be required to sign an entry form which will authorise the organisers to move their sculpture if necessary (for example to cut the grass) or remove it from site for reasons such as public safety or irreparable damage.
12. The utmost care will be taken of all artworks exhibited. The organisers will not be responsible for any damage, loss of or destruction to any works for any reason whatsoever. Artists are responsible for insuring their work against all risks.
13. Insurance – Successful artists will be required to provide proof of suitable public and products liability insurance to a minimum of £5million. In addition, artists should be aware that Council will not indemnify them for any loss or damage to the artworks exhibited.

7. Successful artists

We aim to notify successful artists by e-mail the week **commencing 17 February 2020**. Artists will be required to sign and return a form agreeing to the conditions outlined above.

Invigilation

Artists are asked to volunteer to assist in the invigilating of the exhibition.

This will involve committing to specific times within the time-table.

Invigilating presents the artists with an opportunity to meet the public and talk about their work. They would be free to paint, draw, sketch while in the garden and a table may be available from which the artist may sell small works. No commission will be taken on these sales.

Demonstrations / Workshops

There may also be opportunities for artists to give demonstrations about their work in the garden to accompany the exhibition. If you are interested in demonstrating, please express this in your submission and further details will be provided in due course.

We are hoping to run a school's programme during the exhibition. Successful artists may have the opportunity to be a workshop facilitator.

Any enquiries please email: arts@ardsandnorthdown.gov.uk or Tel: 028 9181 0803